

Free Daily Tours

11am, 12pm, 2:30pm, and Thursday evenings at 6:30pm

Free Spanish Tours

Saturdays at 2pm

Presented by GOYA

Private Group Tours

Available by reservation (rates and restrictions apply)

Connect with #PAMM

Sign up to receive PAMM's calendar of events at pamm.org/calendar.

 /perezartmuseummiami

  @pamm

 pampics

Tell us what you enjoyed about your visit!

 Free Wi-Fi available (Museum Public)

General Museum Hours

Friday, Saturday, Sunday, Monday, Tuesday: 10am–6pm

Thursday: 10am–9pm

Wednesday: Closed

PAMM is closed for Christmas Day and Thanksgiving Day

Admission

Members, Free

Adults, \$16

Seniors (62+ with ID), \$12

Youth (ages 7–18), \$12

Students (with ID), \$12

Children (under 6), Free

Active U.S. Military (with ID), Free

First Thursdays and Second Saturdays, Free

Free First Thursdays is made possible by Knight Foundation.

pamm.org/parking

Metromover: Museum Park station

Free Miami Trolley: Museum Park

Bike racks on site

Self-parking on-site as available (rates apply)*

Parking payment kiosks are located at top and bottom of the the parking stair and elevator as well at garage exit..

Overflow parking at OMNI garage, 1645 Biscayne Blvd.

Accessibility

PAMM is an accessible facility. For more information: vs@pamm.org | 786 345 5629



*All subject to change. Event rates or special conditions may apply.

**PAMM garage is automated and cannot accommodate motorcycles, scooters or small vehicles.



1103 Biscayne Blvd.
Miami, FL 33132
305 375 3000
info@pamm.org
pamm.org

Accredited by the American Alliance of Museums, Pérez Art Museum Miami (PAMM) is sponsored in part by the State of Florida, Department of State, Division of Cultural Affairs, and the Florida Council on Arts and Culture. Support is provided by the Miami-Dade County Department of Cultural Affairs and the Cultural Affairs Council, the Miami-Dade County Mayor and Board of County Commissioners. Additional support is provided by the City of Miami and the Miami OMNI Community Redevelopment Agency (OMNI CRA). Pérez Art Museum Miami is an accessible facility. All contents ©Pérez Art Museum Miami. All rights reserved.



Pérez Art Museum Miami

Museum Map

English



Floor 1
Galleries | Visitor Services | Shop | Restaurant

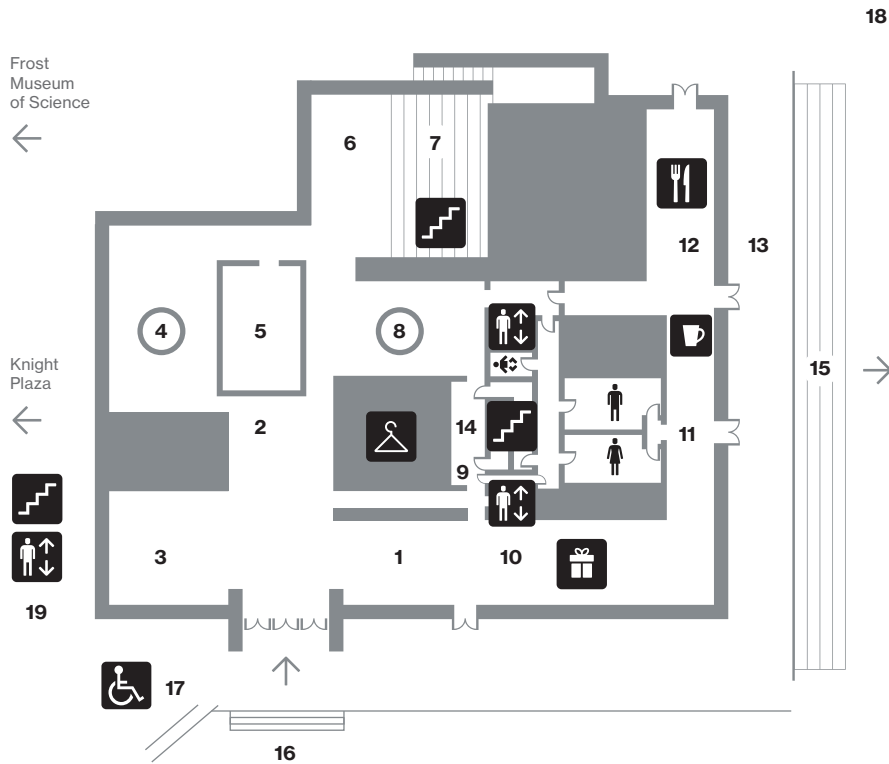

Elizabeth A. and Mitchell Taylor /
Jack Taylor Family Foundation

1 Visitor Services Center

Dorothy and Aaron Podhurst

2 Museum Lobby

Papper Family

3 Gallery

Nedra and Mark Oren

4 Gallery ○

Bank of America

5 Gallery

Padma and Raj Vattikuti

6 Learning Theatre

7 Central Stair / Auditorium 🪑

Lori and Milton Ferrell

8 Gallery ○

9 Bag Check / Lockers 🗳️

Ana Cristina and Edgardo Defortuna Family

10 PAMM Shop 🛒

M. Thérèse Vento

11 Verde Café ☕

Gorson Family Bistro

12 Verde Restaurant 🍴

Pamela Garrison and R. Kirk Landon

13 Terrace

14 Staircase 🪑

Ambassador Paul and Trudy Cejas

15 Bayside Stair 🪑

Sari and Arthur Agatston

16 South Stair 🪑

Jeanne and Joseph Farcus Family

17 Ramp ♿

Mary M. and Sash A. Spencer

18 Sculpture Garden

19 Parking Stair / Elevator 🪑 ♿

Floor 2
Galleries



M.B. Fernandez Family

20 Gallery I ●

Patricia and William Kleh

21 Gallery ●

M.B. Fernandez Family

22 Gallery II ●

23 Gallery ○

Gloria and Howard Scharlin

24 Gallery ○

25 Gallery

Gail S. Meyers and
Andrew C. Hall

26 Gallery

Diane and Robert Moss

27 Gallery

Nedra and Ron Kalish Gallery

28 Gallery ○

Mary M. and Sash A. Spencer

29 Gallery

Neerja Sethi and Bharat Desai

30 Gallery ○

Rose Ellen Meyerhoff Greene
and Gerald Greene

31 Gallery

32 Gallery

Paresky

33 Hall

The Rosenberg Family Foundation

34 Gallery Passage

Key

- Permanent Collection
- Special Exhibitions

Photography and videography

Photography for personal use only. Check all cameras with removable lenses in the Bag Check. Photography is not permitted in some galleries due to copyright restrictions. Commercial photography and videography must be pre-arranged through events@pamm.org.

Sketching

Visitors are welcome to sketch in the galleries. We ask that you use only pencil (no ink or paint, please) and keep sketchbooks to size 8 1/2 x 11 inches. Easels, stools, or sketching while sitting on the floor is not permitted.

Strollers

Baby strollers are permitted at all times, however please check oversized bags, food or drink accompanying stroller.

Help protect the art

Please do not touch the artwork on display. No smoking, food or drinks: Food and drinks are permitted only in the lobby and may not be carried into the galleries or other areas.